

**WHERE TO FIND US**  
821 Marquette Avenue  
Minneapolis, MN, 55402  
612.215.3700

**WMINNEAPOLISHOTEL.COM**

©2016 Starwood Hotels & Resorts  
Worldwide, Inc. All Rights Reserved.  
W is the trademark of Starwood  
Hotels & Resorts Worldwide, Inc.,  
or its affiliates.

spg<sup>\*</sup>  
Starwood  
Preferred  
Guest

MINNEAPOLIS

**THE HISTORICAL  
W MINNEAPOLIS -  
THE FOSHAY  
INSPIRES  
INNOVATIVE STYLE  
IN A SOARING  
ICON OF ART DECO  
SPLENDOR.**

**W**  
MINNEAPOLIS  
THE FOSHAY

**229 GUEST  
ROOMS**  
**360 DEGREE  
VIEWS**  
**6700 SQ. FT.  
OF EVENT  
SPACE**  
**1 FABULOUS  
HOTEL**

**STAY  
AWHILE**



## DREAM ON

### GUEST ROOMS

Stay on top of the surging urban scene in 229 rooms with spectacular views of the skyline and lush landscapes, also featuring the signature W bed, delightful Mix Bar, wireless technology and fabulous entertainment. Stay socially connected during your escape by getting the download from your friends and co-workers via the oversized desk that is outfitted with High-Speed Internet access. When relaxation calls, soak in the scenery and the soothing sensation of the legendary Bliss lemon + sage Sinkside Six.

### WOW & EXTREME WOW SUITES

Located on the highest floors, these suites showcase urban art deco splendor. The WOW suite wraps around the tower aloft from the bustle below, and is where the artistry of the Roaring Twenties meets contemporary cool. Complete with a spacious living room and modern luxuries throughout for every whim and fancy, there's plenty of room for everyone and everything you wish to do under the bright lights crafted with chandelier-like baubles.

When we say wow we mean it. The Extreme Wow two-bedroom suite wraps around the top of the tower, where your view of Minneapolis is panoramic and spies on the city from every angle, bringing new perspective to the term "urban landscape."

### STARWOOD PREFERRED GUEST® SPG PRO®

Guests enjoy access to the award-winning Starwood Preferred Guest® program, where you can earn free nights at over 1,200 hotel in 100 countries.

SPG Pro® provides rewards and recognition for meeting planners. As a member of SPG Pro, you'll earn Starpoints for every meeting and event you book and no blackout dates. For more information, visit [spgpro.com](http://spgpro.com).

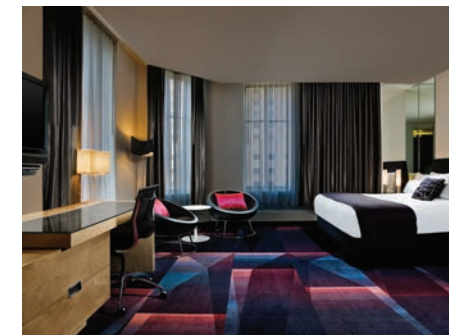

# PULSE



## MADE TO MINGLE

### LIVING ROOM

Welcome to not your ordinary Living Room. Watch the action unfold, or create your own in intimate seating areas along the original Art Deco arcade. Groove to live DJ mixes or sip a signature cocktail set amongst decor inspired by art deco cool of the Roaring Twenties, where you'll sink into plush, oversized furniture or get tied up in cheeky chairs with corset backs. Steal away through a secret door in the wall into our Speakeasy—a stylish private space for those more intimate occasions.

### MANNY'S STEAKHOUSE

Recently named one of the 10 Best Steakhouses in the World by Men's Journal, Manny's serves USDA-certified, dry-aged, center-cut beef, hand trimmed by master butchers. Our menu reflects the availability of locally sourced ingredients offering chops, chicken and premium fresh vegetables. Count on stone crab claws and fresh Alaskan King Crab legs when they're available, along with specialty cuts of steak.

For subtler pleasures, peruse Manny's wine list. In addition to a 300-bottle regular list, there is also an extensive reserve list with deeper vintages. Reservations recommended.

### IN-ROOM DINING

If you feel like staying in, we offer a full in-room dining menu that's available 24 hours a day. From classic breakfast to late night noshes, we're here for you.

### PROHIBITION BAR

Our quiet escape at the top of the world. You're invited for a cocktail among the clouds, as you lounge in Wilbur Foshay's old office and boardroom by original windows, stairs and African mahogany woodwork. Whether you're up for socializing at the bar or prefer the intimacy of secluded seating areas, enjoy the colorful signature W drinks list, sparkling champagne collection for celebrations and an extensive list of fine wines and vintages—yes, we have a cellar all the way up here.

Anywhere you turn, full windows present breathtaking views of the city below and on a clear day, you can see forever. Hosting a dinner for two or high-powered session? Mr. Foshay's personal boardroom is available for private events.

# ESCAPE

A photograph of the W Minneapolis lobby. The ceiling is a vibrant pink with a geometric, faceted design. The walls are a warm, textured brown. The floor is made of large, multi-colored tiles in shades of pink, red, and brown, arranged in a complex geometric pattern. In the center of the lobby, there are two curved, illuminated reception desks. The background wall features two large white 'W' logos. The lighting is warm and ambient, creating a modern and sophisticated atmosphere.

## FEATURES

### WHATEVER/WHENEVER®

We'll turn dreams into reality at the touch of a button. Just tell us what you want. We'll deliver it. At W Minneapolis, we really mean that. Just push the WHATEVER/WHENEVER® button on your phone and we will deliver whatever you desire directly to your guest room. We don't even need a magic wand—just the creativity and innovation of the W team. Whether reserved seating at a Twin's game or securing a pass to an art opening, we're here to make it happen.

### WIRED

You'll never get your wires crossed in WIRED, our 24 hour business center. Get the download from your friends or co-workers and stay connected with our fleet of Mac/PC compatible computers, printers, scanners, fax machines, audio/visual and telecommunications equipment, High Speed Internet Access and more. Hot off the presses to hit the runway, we'll also print your boarding pass as a complimentary service.

### FIT®

In our 720-square-foot, state-of-the-art, fully-equipped FIT gym, stretch high and reach for the sky where energizing is easy, whether you prefer yoga, pilates or just jogging. Gym rats and fitness warriors will love the comprehensive array of treadmills, elliptical machines and stationary bikes mounted with LCD TVs, weight machines, free weights, boxing bag/gloves, yoga mats and balance balls. All guests enjoy complimentary access with their room key.

### FOSHAY TOWER OBSERVATION DECK

Explore the Foshay Tower observation deck during your next visit to Minneapolis. The Foshay Tower was the first skyscraper built in the state of Minnesota and remained the tallest building in Minneapolis from 1929-1972. It's significant as a unique example of architectural design and engineering and was placed on the National Register of Historic Places in 1977. In 2008, the renovated Foshay Tower reopened as W Minneapolis - The Foshay.

### P.A.W. - PETS ARE WELCOME

With W Minneapolis' signature Pets Are Welcome™ (P.A.W.) program we ensure that your furry friends enjoy their escape just as much as you. Pamper your animal companion with a custom W Pet Bed and a pet treat, or take a trip to Minneapolis' coolest dog boutiques by speaking with our W concierge.

# MEET



## WHERE MINDS MEET

12 UNIQUE MEETING SPACES  
TOTALING 6,700 SQUARE FEET

W Minneapolis - The Foshay features fully adaptable conference equipment that makes business beautiful, meetings memorable and special events spectacular. Creative in approach and innovative in design, we'll engage and energize your attendees and participants, from conferences to soirées. You'll see what we mean when you enter our Great Room, awash in the glow of natural sunlight and offering sweeping city views overlooking Marquette and 9th Avenues in downtown Minneapolis. As your guests mingle in our pre-function space, they're always on top of the action with a splendid perspective of the Living Room below. Our creative and innovative team of professionals will help ensure your next event is a superb success.

## HOTEL AT A GLANCE

Year Opened: 2008

Guest Rooms: 229

Kings/Suites/Doubles: 200/18/11

Ideal Group Size: 80 guests or fewer

Max Group Size: 210 guests

Airport Proximity: Distance - 13 miles

## MEETING SPACES

Largest Event Space: 3,080 sq. ft.





SECOND FLOOR

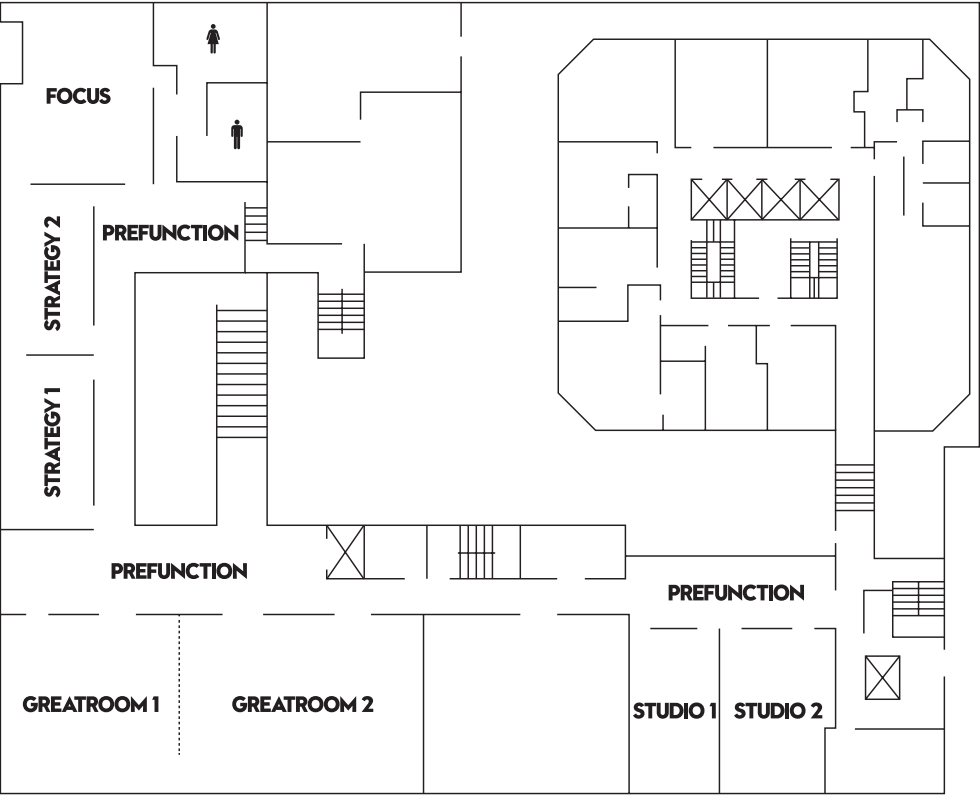

CAPACITY CHART

Room Name	Dim. (l x w)	Area	Height	Banq.	Thtr.	Conf.	Rec.	Class	U-Shp.
First Floor									
Great Room	88.0' x 35.0'	3,080ft²	10.0'	230	254	-	342	140	-
Great Room 1	37.0' x 35.0'	1,295ft²	10.0'	100	106	42	142	58	36
Great Room 2	51.0' x 35.0'	1,785ft²	10.0'	130	148	60	198	80	50
Great Room Prefunction									
Studio 1	19.0' x 33.0'	627ft²	10.0'	40	52	20	70	28	18
Studio 2	22.0' x 33.0'	726ft²	10.0'	50	60	24	80	32	20
Studio Prefunction									
Strategy 1	18.0' x 36.0'	648ft²	10.0'	-	-	20	-	-	-
Strategy 2	18.0' x 35.0'	630ft²	10.0'	40	52	20	70	28	18
Strategy Prefunction									
Focus	35.0' x 30.0"	1,050ft²	10.0'	80	88	34	116	48	30

EXPLORE

MINNEAPOLIS ATTRACTIONS

Welcome to the metropolis of Minneapolis. We are conveniently skyway connected so you can shop, eat and explore downtown without ever braving the weather. Known as the modern and hip twin to the more conservative and quiet St. Paul, Minneapolis is home to the area’s financial district, just steps from W Minneapolis - The Foshay. You’re also in the city’s hot spot of architectural and cultural gems, such as the Hennepin Theater District, the Minnesota Opera, the Minneapolis Institute of Arts, the Weisman Art Museum, Orchestra Hall, the Walker Arts Center and Sculpture Garden and the new Guthrie Theatre. Jocks, take heart—the Timberwolves hoop it up at Target Center and the Twins and Vikings call the Metrodome home, all within walking distance of the hotel.

ARTS & CULTURE

Hennepin Theater District: 0.2 mi.  
Orpheum Theatre: 0.3 mi.  
Historic State Theatre: 0.3 mi.  
Minneapolis Institute of Arts: 1.0 mi.  
Walker Art Center and Sculpture Garden: 1.0 mi.  
Guthrie Theater: 1.0 mi.  
The Minnesota Opera: 2.0 mi.

COMMUNITY

Minneapolis Convention Ctr.: 0.3 mi.  
University of Minnesota 3.0: mi.  
St Jude’s Medical Center 5.0: mi.  
Aveda Institute: 20.0 mi.  
Mayo Clinic Rochester, MN: 75.0 mi.

CORPORATE OFFICES

Xcel Energy: 1.0 mi.  
Allianz Ag 5.0: mi.  
General Mills: 7.0 mi.  
Best Buy Corporate Headquarters: 10.0 mi.  
Medtronic: 12.0 mi.  
Cargill: 15.0 mi.  
Guidant Corporation: 5.0 mi.  
UnitedHealth Group: 17.0 mi.

GOLF

Edgebrook Golf Course: 18.0 mi.

LOCAL ATTRACTIONS

Orchestra Hall: 0.1 mi.  
Mystic Lake Casino: 28.0 mi.

RECREATION

Target Center: 0.3 mi.  
Xcel Energy Center: 9.0 mi.

SHOPPING

Nicollet Mall: 0.1 mi.  
Macy’s 0.2: mi.  
Mall of America: 10.0 mi.

